



BLATCH
FINE HOMES

Tel: +44 (0) 24 7624 9333

info@blatchfinehomes.co.uk



9 Leas Close

Ullesthorpe, Lutterworth, LE17 5FY

£745,000



5



4



2



B

9 Leas Close



Description

An executive five bedroom detached residence situated within an exclusive development comprising of only nine impeccably crafted homes nestled in a highly sought-after neighbourhood.

Welcome to this beautifully presented property on Leas Close, located in the sought-after village of Ullesthorpe and offering stunning rural views. Thoughtfully designed, this home has been built with modern living in mind, combining comfort, practicality, and style. Every detail has been considered to maximise the position and layout, flooding the home with natural light and enhancing the sense of space from the moment you walk in.

- New Home
- Five Generously Sized Double Bedrooms and Three En-Suites
- Stunning Interiors
- New Build Warranty Included
- EPC Rating B
- Beautiful Countryside Views
- Open Plan Kitchen-Diner
- Neff Appliances
- Double Garage
- Council Tax Band D





Floor Plan

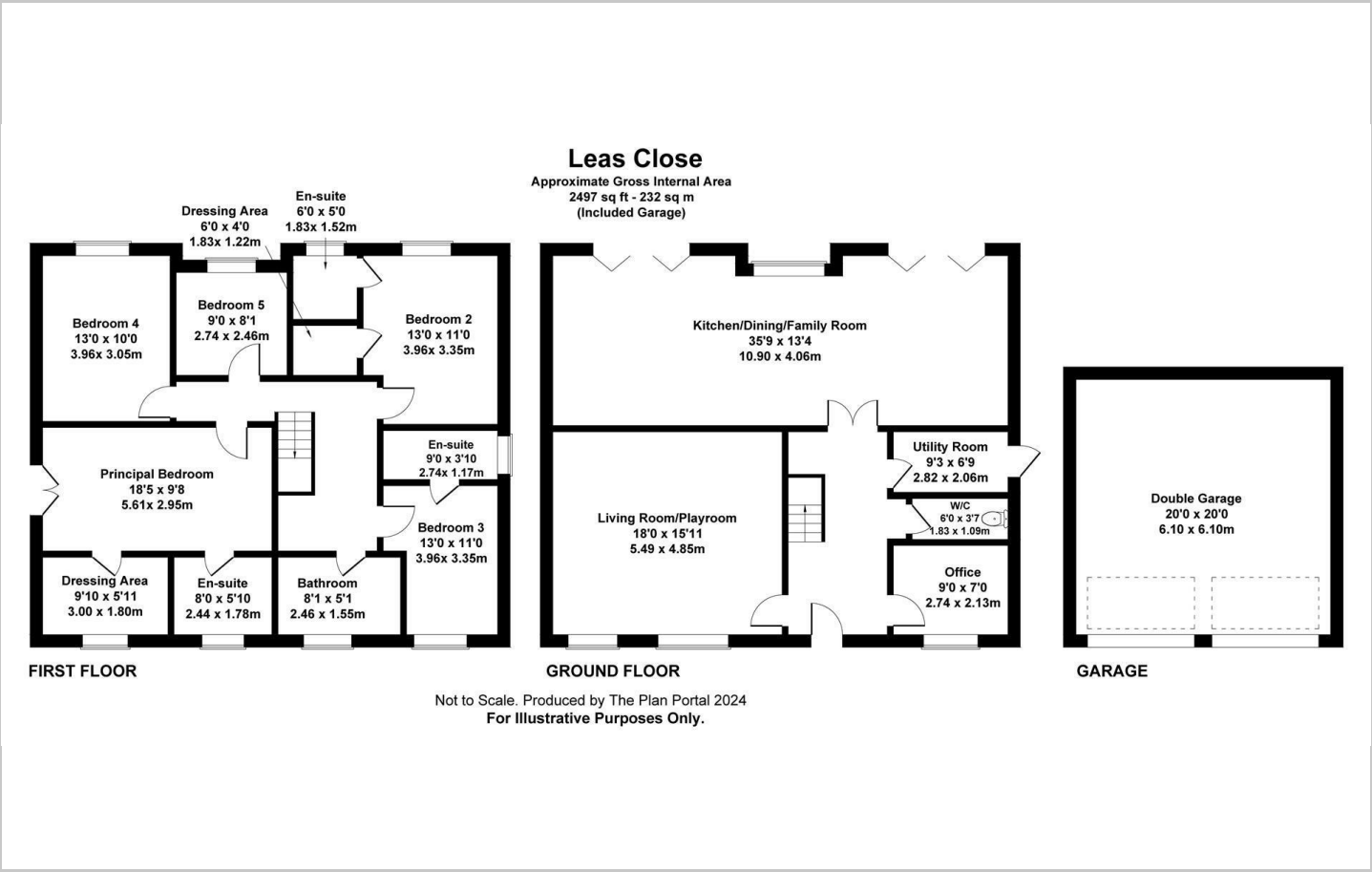

Area Map



Viewing

Please contact our Coventry Office on 02476249333 if you wish to arrange a viewing appointment for this property or require further information.

These particulars, whilst believed to be accurate are set out as a general outline only for guidance and do not constitute any part of an offer or contract. Intending purchasers should not rely on them as statements of representation of fact, but must satisfy themselves by inspection or otherwise as to their accuracy. No person in this firms employment has the authority to make or give any representation or warranty in respect of the property.

Energy Efficiency Graph

